

RETAIL SPACE FOR LEASE

NORTHWESTERN HIGHWAY PLAZA

28565 NORTHWESTERN HIGHWAY

SOUTHFIELD, MICHIGAN

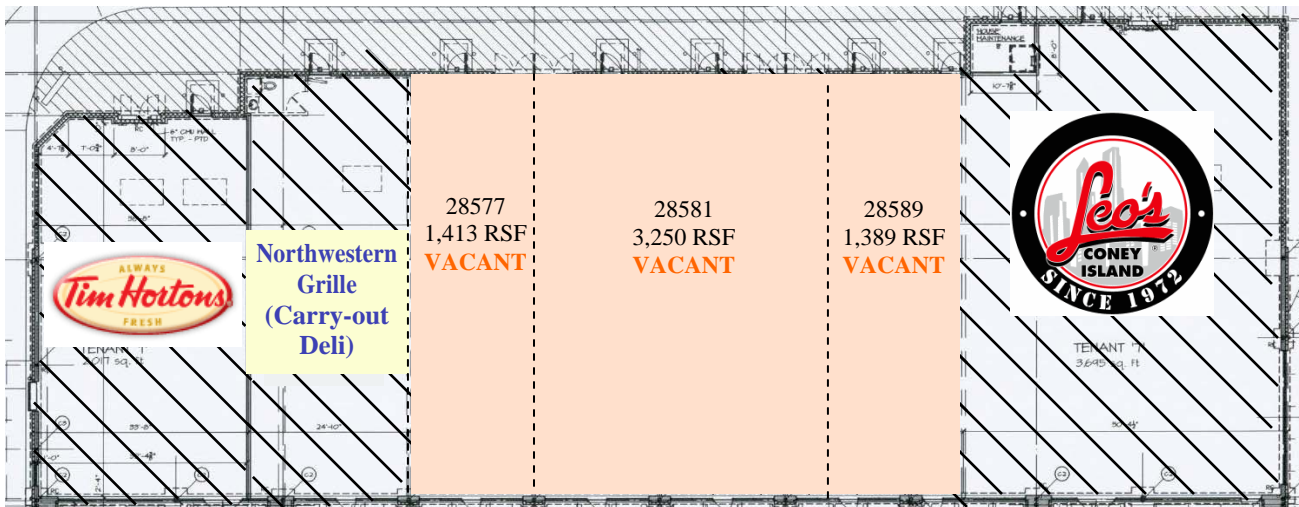

Property Developed and Managed by:

ARI-EL

Ari-El Enterprises, Inc.

29548 Southfield Road, Suite 200

Southfield, MI 48076-2028

(248) 557-3800 Fax (248) 557-6442

www.ari-el.com

Mmeredith@ari-el.com

ScottL@ari-el.com

For further information

please contact:

Marilyn Meredith

or

Scott M. Leibovitz

Information is subject to verification and no liability for errors or omissions is assumed. Price and terms are subject to modification.

NORTHWESTERN HIGHWAY PLAZA

28565 Northwestern Hwy.

About 1/4 mile south of 12 Mile on the southbound side of Northwestern, just before Beck, which leads drivers to the new westbound entrance ramp to I-696.



TRAFFIC COUNTS:

Northwestern Hwy. 67,000 VPD - north of I-696
139,700 VPD - at Telegraph (2006)

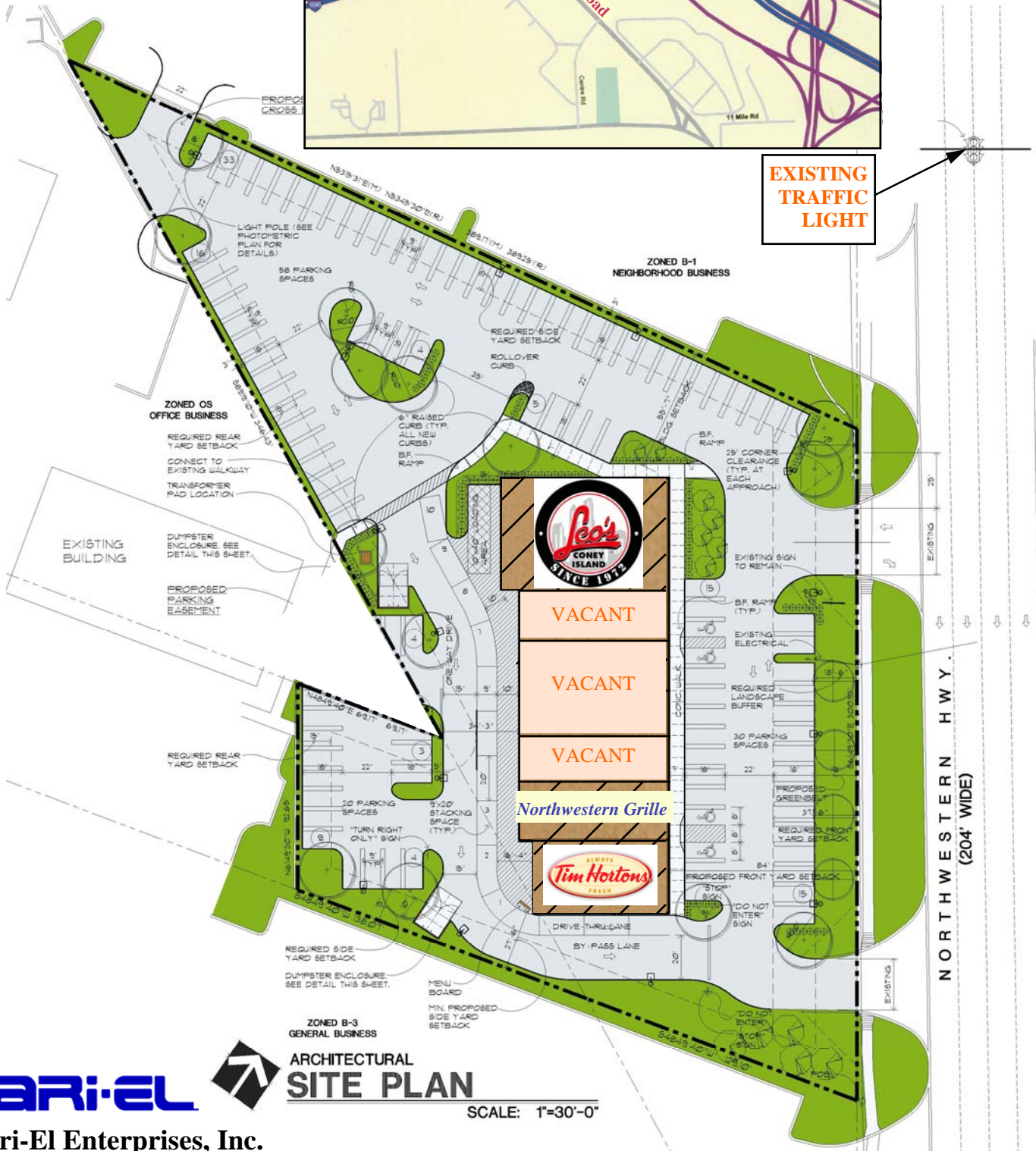

ARCHITECTURAL SITE PLAN

SCALE: 1"=30'-0"

Ari-El Enterprises, Inc.