

PRIME INDUSTRIAL SPACE FOR LEASE

FRASER COMMERCE CENTER

FRASER, MICHIGAN



- ◆ 8,080 - 16,160 SF Available
- ◆ 18321-18333 Mike C. Court
- ◆ Approx. 1,000 SF of office in each unit
- ◆ Mezzanine storage above office areas
- ◆ 240/480/2000 Amps
- ◆ Buss duct & exhaust fans
- ◆ Radiant Heat
- ◆ 16' 8" Clear Height
- ◆ 2 12' x 14' Overhead Doors (one in each unit)
- ◆ 2 8' x 8' Overhead Doors (one in each unit)
- ◆ 40' Bay

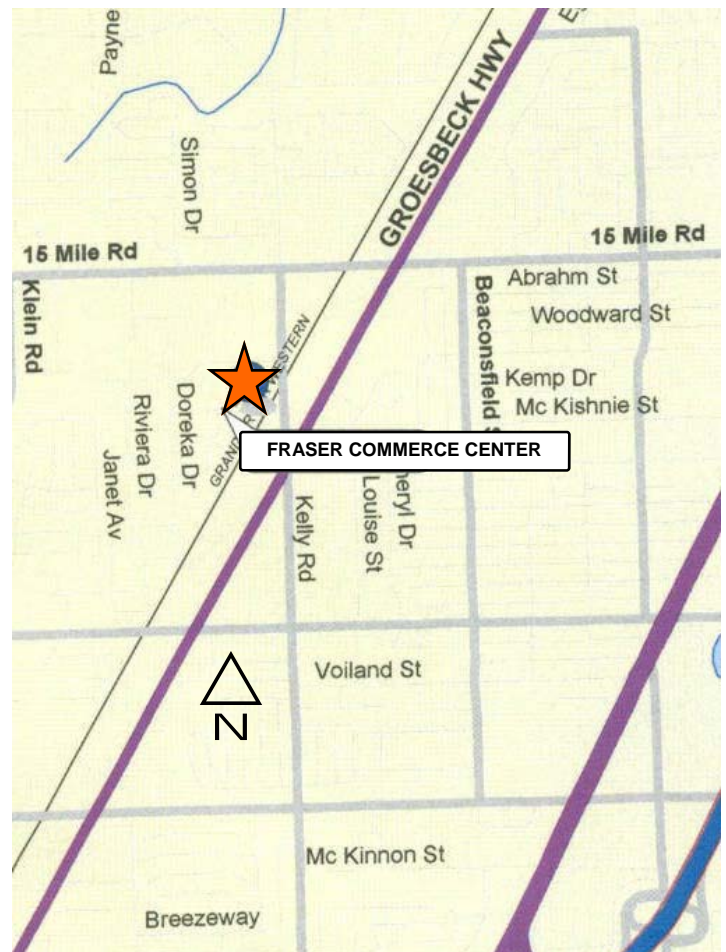

For further information or
to schedule a tour,
please contact:

**Scott Leibovitz or
Marilyn Meredith**
248-557-3800

Property Managed by:

ARI-EL

Ari-El Enterprises, Inc.

29548 Southfield Road, Suite 200
Southfield, MI 48076-2028

(248) 557-3800 Fax (248) 557-6442

www.ari-el.com

Information is subject to verification and no liability for errors or omissions is assumed. Price and terms are subject to modification.



Managed by:

ARI-EL

Ari-El Enterprises, Inc.
(248) 557-3800
www.ari-el.com

Fraser Commerce Center
18321-18333 Mike C Court, Fraser, MI

Approx. 16,160 square feet
Approx. 2,000 square feet of office

9.13.2010

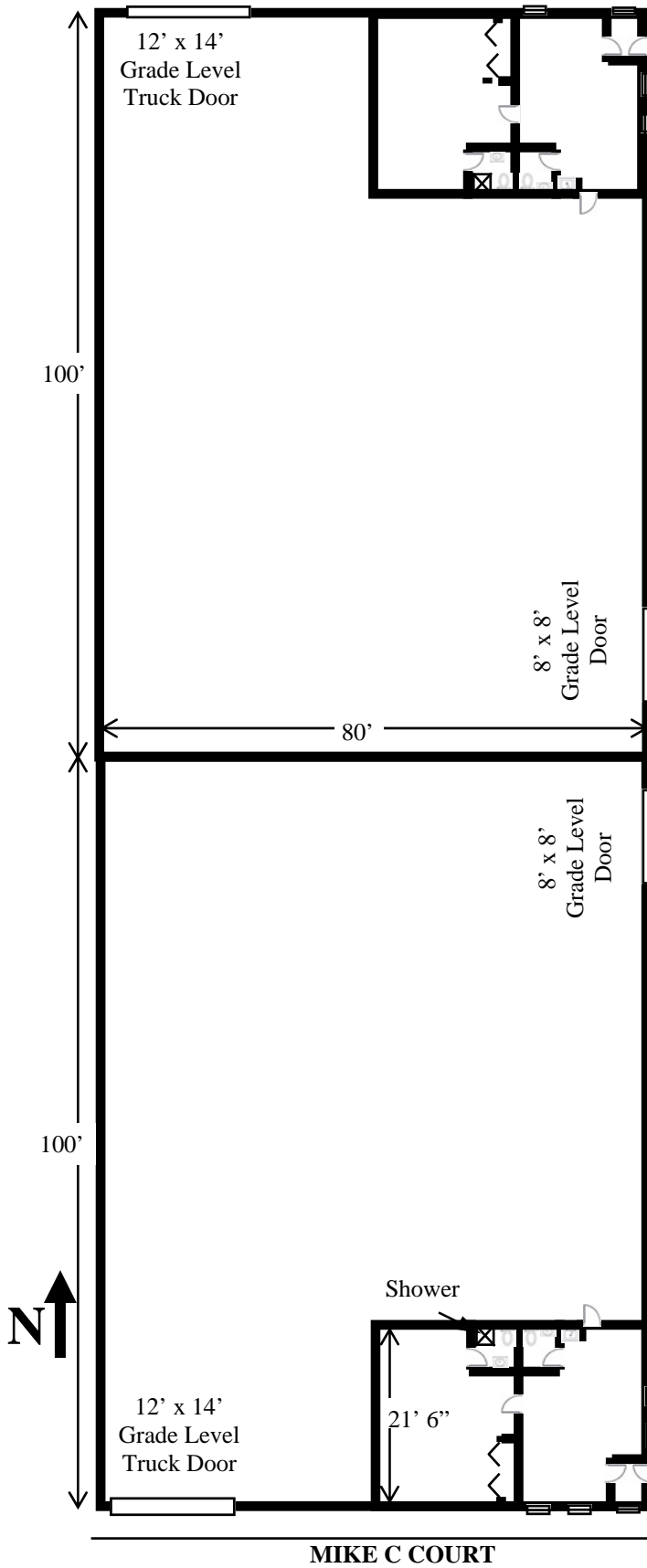

Managed and Leased by:

ARI-EL

Ari-El Enterprises, Inc.

(248) 557-3800

www.ari-el.com

Fraser Commerce Center

18321-18333 Mike C Court, Fraser, MI

Approx. 16,160 square feet

Approx. 2,000 square feet of office

Not to Scale

Dimensions and positions of walls are approximate and subject to verification

9.13.2010



Fraser Commerce Center
18321-18333 Mike C Court
Fraser, MI

Approx. 16,160 square feet
Approx. 2,000 square feet of office

9.13.2010