

PRIME INDUSTRIAL SPACE FOR LEASE

FRASER COMMERCE CENTER

FRASER, MICHIGAN



- ◆ 8,080 SF Available
- ◆ Approx. 775 SF of office
- ◆ Mezzanine storage above office area
- ◆ 240/480/2000 Amps
- ◆ Buss duct & exhaust fans
- ◆ Radiant Heat
- ◆ 16' 8" Clear Height
- ◆ 1 12' x 14' Overhead Door
- ◆ 1 8' x 8' Overhead Door
- ◆ 40' Bay

18321 Mike C. Court

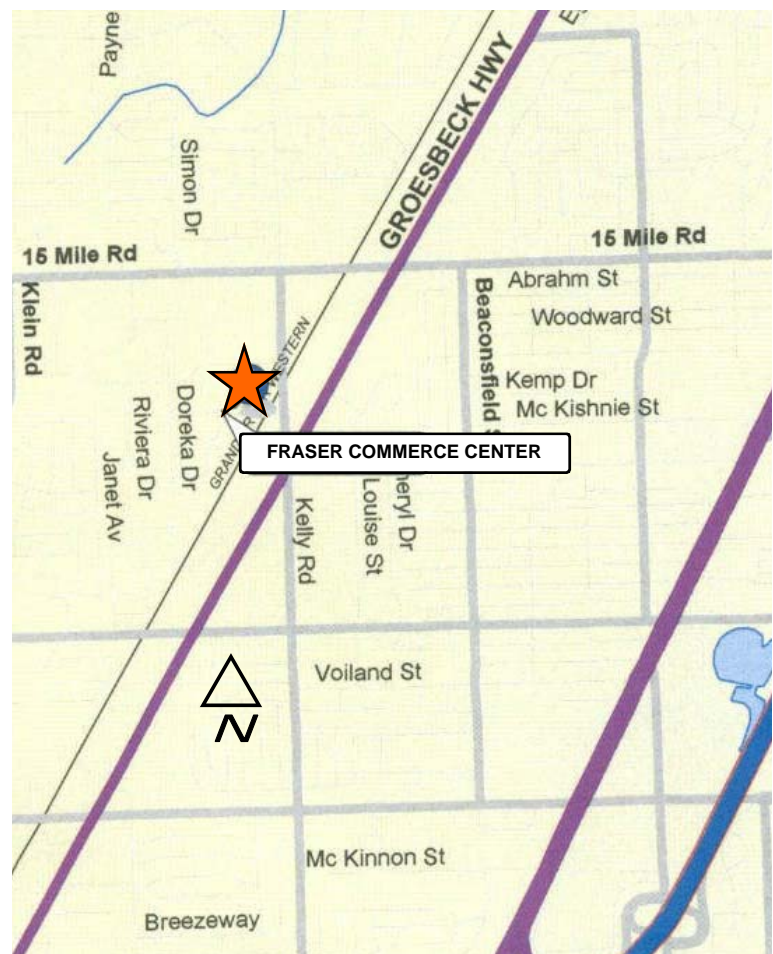

For further information or
to schedule a tour,
please contact:
**Scott Leibovitz or
Marilyn Meredith**
248-557-3800

Property Managed and Leased by:

ARI-EL

Ari-El Enterprises, Inc.

29548 Southfield Road, Suite 200

Southfield, MI 48076-2028

(248) 557-3800 Fax (248) 557-6442

www.ari-el.com

Information is subject to verification and no liability for errors or omissions is assumed. Price and terms are subject to modification.

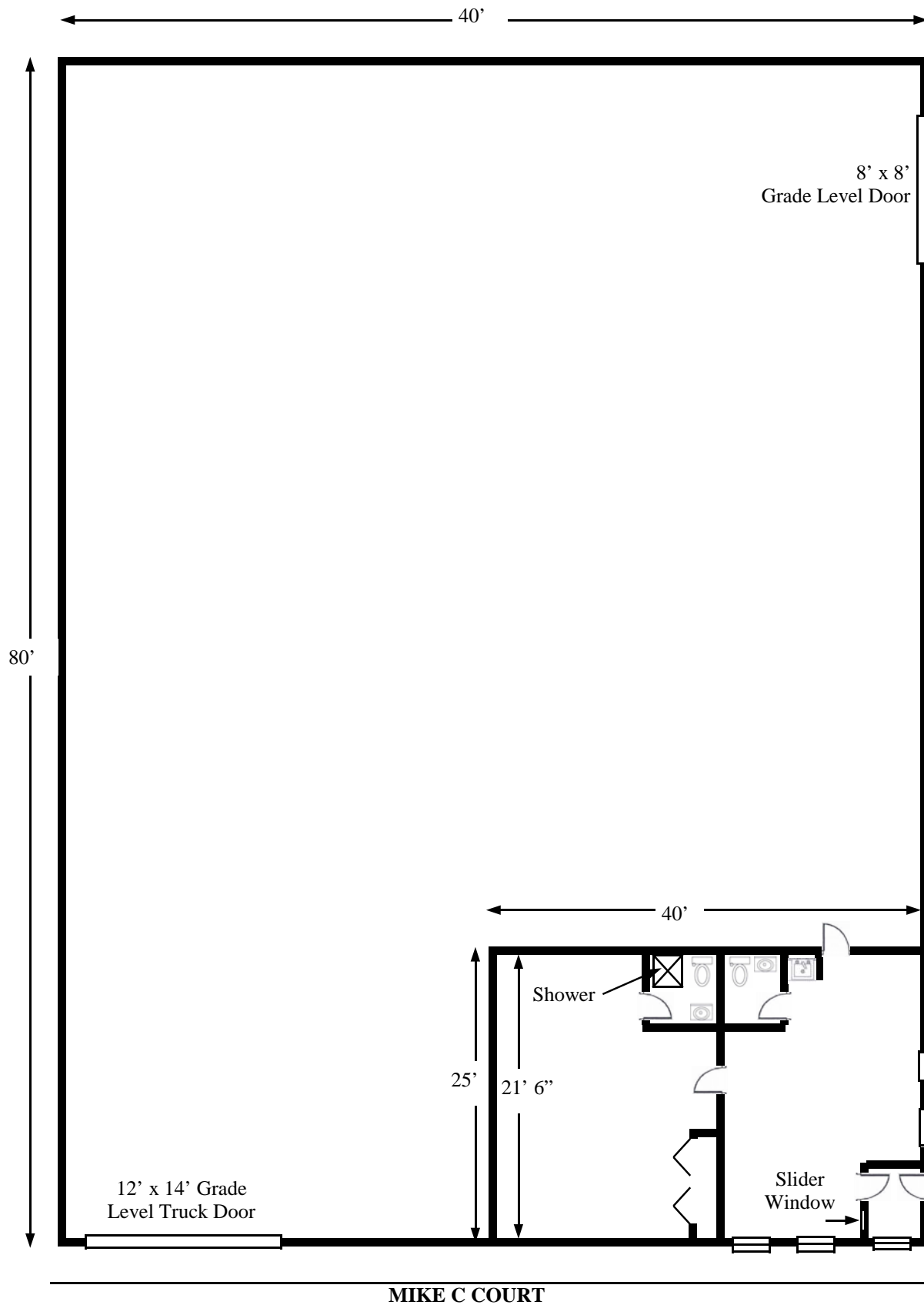

Managed and Leased by:

ARI-EL

Ari-El Enterprises, Inc.

(248) 557-3800

www.ari-el.com

Fraser Commerce Center
 18321 Mike C Court, Fraser, MI

Approx. 8,080 square feet
 Approx. 1,000 square feet of office

Not to Scale

Dimensions and positions of walls are approximate and subject to verification

10.3.2008