

**DRASTIC
SALE PRICE
REDUCTION!**
~~\$1,100,000~~
\$795,000

INDUSTRIAL BUILDING FOR SALE OR LEASE 15,400 SQUARE FEET DIVISIBLE

**UP TO
ONE YEAR
FREE
RENT**
Make Offer



650 Mandoline, Madison Heights

1 block east of John R and 1 block south of 14 Mile Road

- ◆ 15,400 SF Building
- ◆ 2,400 SF of Office
- ◆ Zoned Light Industrial
- ◆ 16' Clear in Warehouse
- ◆ 2 Grade Level Doors
- ◆ Heavy Power
- ◆ Adequate Parking
- ◆ Can be duplexed
- ◆ EASY FREEWAY ACCESS

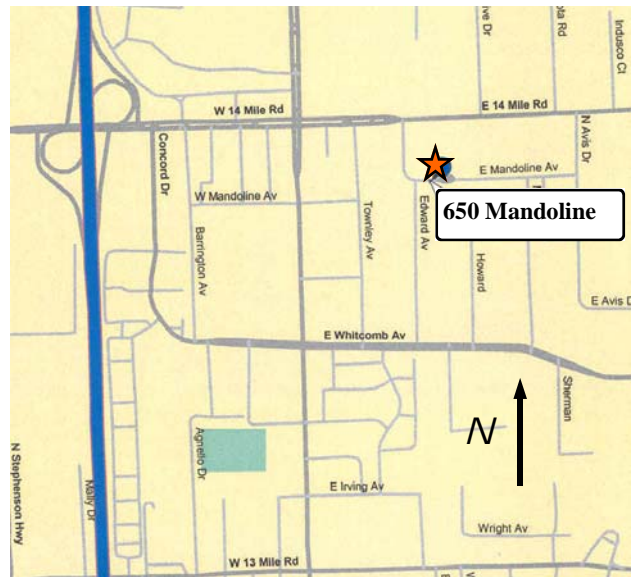

Property Managed and Leased by:

ARI-EL

Ari-El Enterprises, Inc.

29548 Southfield Road, Suite 200
Southfield, MI 48076-2028

(248) 557-3800 Fax (248) 557-6442

www.ari-el.com

Mmeredith@ari-el.com

ScottL@ari-el.com

**For further information or
to schedule a tour,
please contact:
Marilyn Meredith
or
Scott M. Leibovitz**

Information is subject to verification and no liability for errors or omissions is assumed. Price and terms are subject to modification.

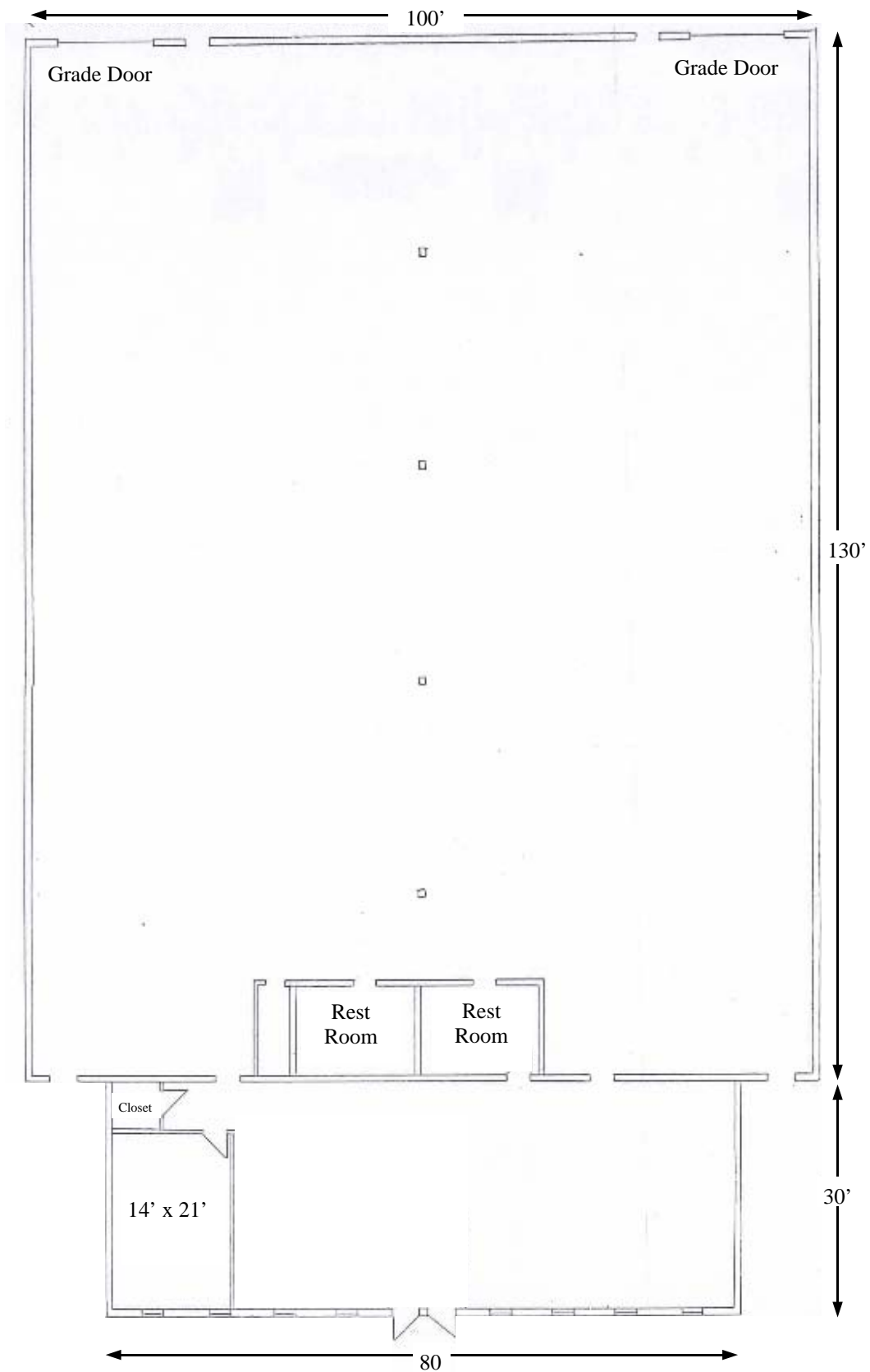

Leased and Managed by:

ARI-EL

Ari-El Enterprises, Inc.

(248) 557-3800

www.ari-el.com

650 Mandoline

Madison Heights, MI

Approx 15,400 sq. ft.

Not to Scale

Dimensions and positions of walls are approximate and subject to verification