

INDUSTRIAL BUILDING FOR SALE OR LEASE

**27,730 SQUARE FEET
ROCHESTER HILLS, MI**

**UP TO
ONE YEAR
FREE
RENT
Make Offer**



2700 BOND STREET

Excellent location just north off Auburn Road and west of Crooks Road

- ▶ Perfect for Warehousing or Manufacturing
- ▶ Remodel to suit
- ▶ Single Tenant Building
- ▶ Zoned Light Industrial
- ▶ Approx. 3,570 Sq. Ft. Office
- ▶ 19' Clear in Warehouse
- ▶ Truck Well
- ▶ 12' x 14' Grade Level Door
- ▶ Parking for 52 Vehicles

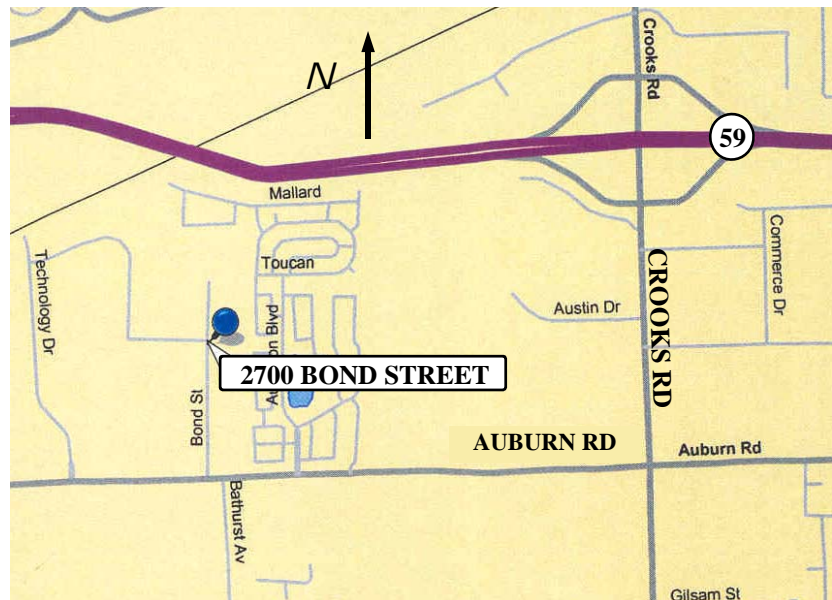

Property Managed by:

ARI-EL

Ari-El Enterprises, Inc.
29548 Southfield Road, Suite 200
Southfield, MI 48076-2028
(248) 557-3800 Fax (248) 557-6442
www.ari-el.com
Mmeredith@ari-el.com
ScottL@ari-el.com

For further information or to schedule a tour,

please contact:

Paul Hoge
Signature Associates
248-948-0103

paulhoge@signatureassociates.com

Information is subject to verification and no liability for errors or omissions is assumed. Price and terms are subject to modification.

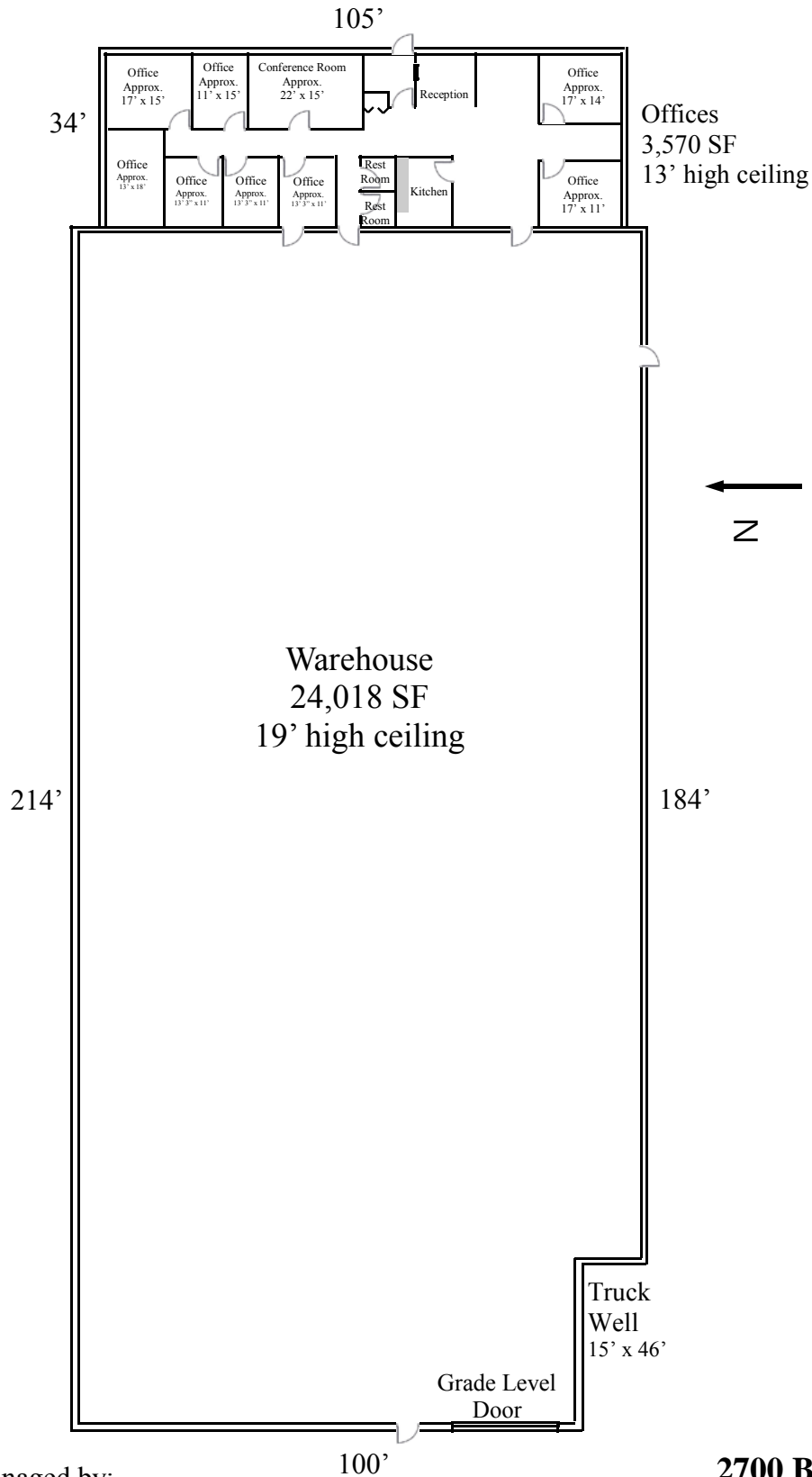

Leased and Managed by:

ARI-EL

Ari-El Enterprises, Inc.
(248) 557-3800
www.ari-el.com

2700 Bond Street
 Rochester Hills, MI

Approx. 27,733 sq. ft.

Not to Scale
 Dimensions and positions of walls are approximate
 and subject to verification

