

WEST BLOOMFIELD INDUSTRIAL BUILDING FOR SALE OR FOR LEASE APPROX. 58,700 SQUARE FEET

2000 HAGGERTY ROAD, WEST BLOOMFIELD



- ◆ Approx. 58,700 SF
- ◆ Approx. 11,475 SF of Office (some on 2nd floor)
- ◆ Great for Basic Storage
- ◆ 2 Dock High Doors
- ◆ 4 Interior Dock High Doors
- ◆ 5 Grade Level Doors
- ◆ +/-9 Acres of Land
- ◆ Zoned I-OP (Industrial-Office Park)
- ◆ Ideal Redevelopment Opportunity to Commercial or Office
- ◆ **Very Aggressive Lease Rate!!**

For further information or
to schedule a tour, please contact:
Arie Leibovitz (248) 763-1188

Property Managed and Leased by:

ARI-EL

Ari-El Enterprises, Inc.

29548 Southfield Road, Suite 200
Southfield, MI 48076-2028

(248) 557-3800 Fax (248) 557-6442

www.ari-el.com

arie@ari-el.com

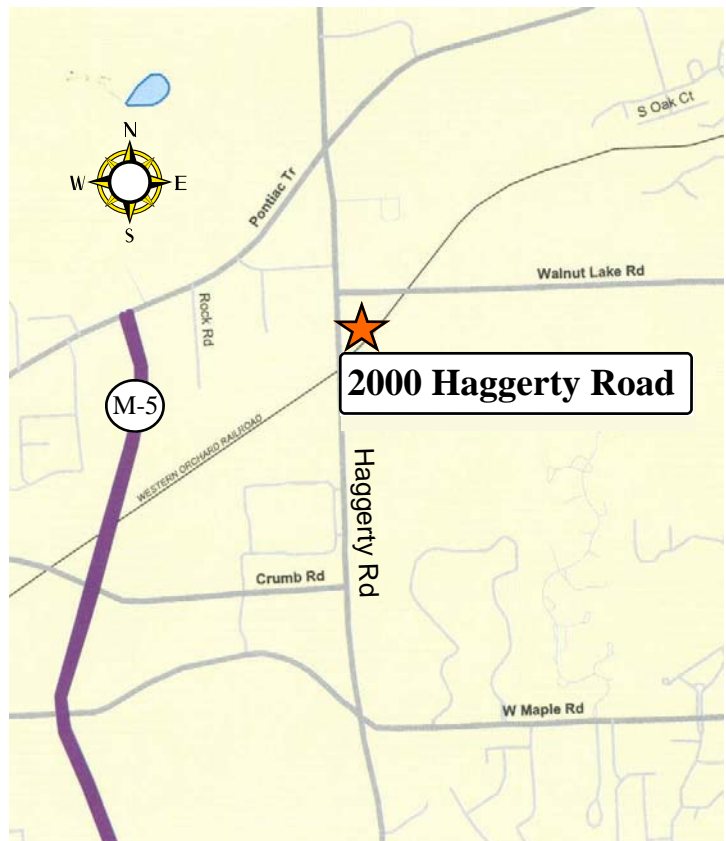

Information is subject to verification and no liability for errors or omissions is assumed.

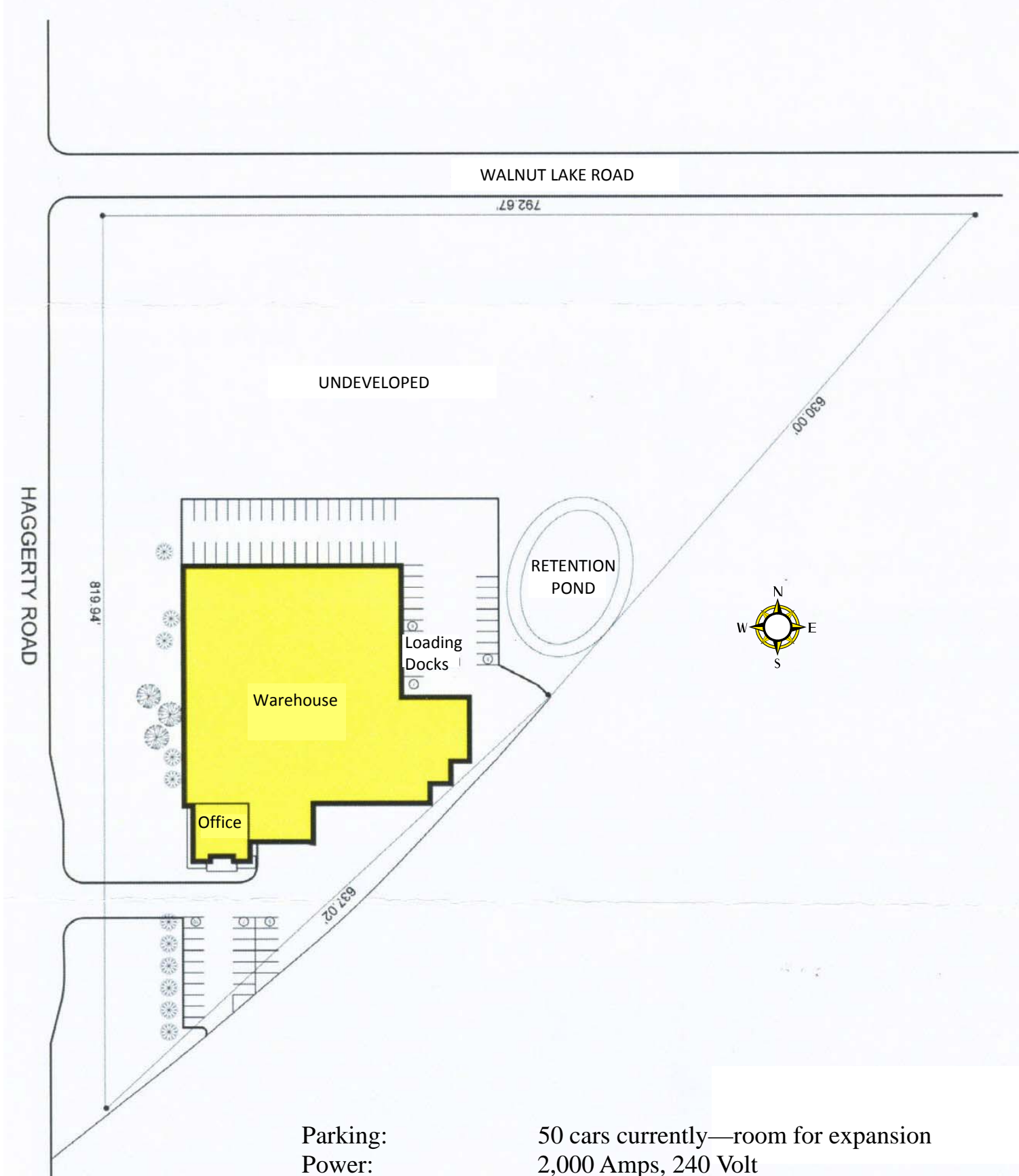

Parking:	50 cars currently—room for expansion
Power:	2,000 Amps, 240 Volt
Ceiling Clear:	9' 8" - 18' 9"
Building sits on:	Approx. 3 Acres
Undeveloped Land:	Approx. 6 Acres

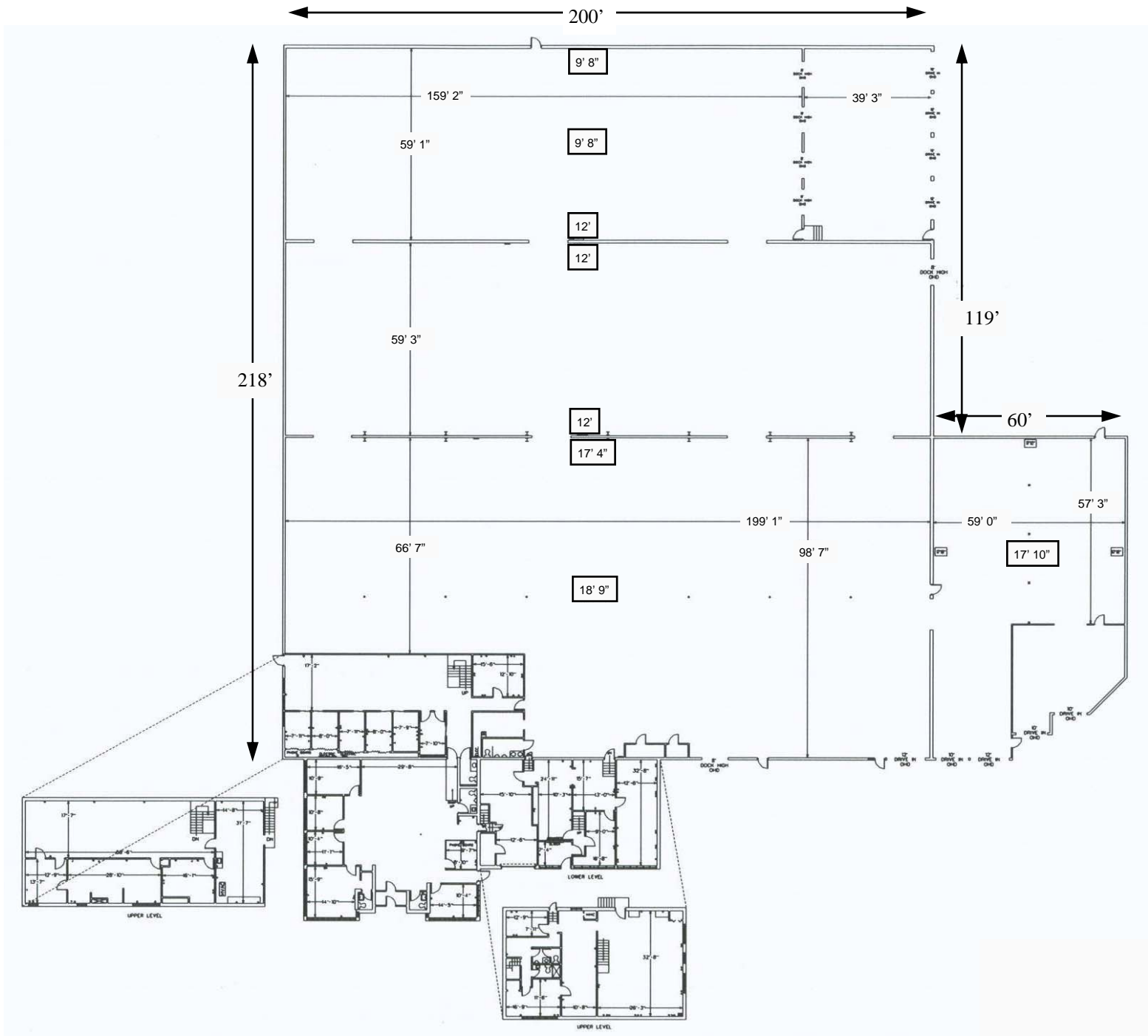

2000 Haggerty Road
West Bloomfield, MI

Leased and Managed by:

ARI-EL

Ari-El Enterprises, Inc.
(248) 557-3800
www.ari-el.com

Approx. **58,700 sq. ft.**

Approx. 7,000 SF of first floor office
Approx. 4,475 SF of second floor office

3 Grade Level Doors

2 Exterior Truck Docks

4 Interior Dock High Doors

