

*Newly
Renovated
Common
Areas*

PRIME OFFICE SPACE FOR LEASE BLOOMFIELD HILLS, MICHIGAN



10 West Square Lake Road, Bloomfield Hills, MI 48302

Excellent location on the northwest corner of Square Lake Road and Woodward Avenue

- ◆ Excellent Bloomfield Hills Location
- ◆ Easy Access to I-75
- ◆ Close to Restaurants and Shopping at Kingswood Plaza Shopping Center
- ◆ General Office or Medical
- ◆ Cable Modem & TV Access Available
- ◆ Three Floors with Elevator
- ◆ Ample Free Parking
- ◆ 1/4 mile south of St. Joe's Hospital

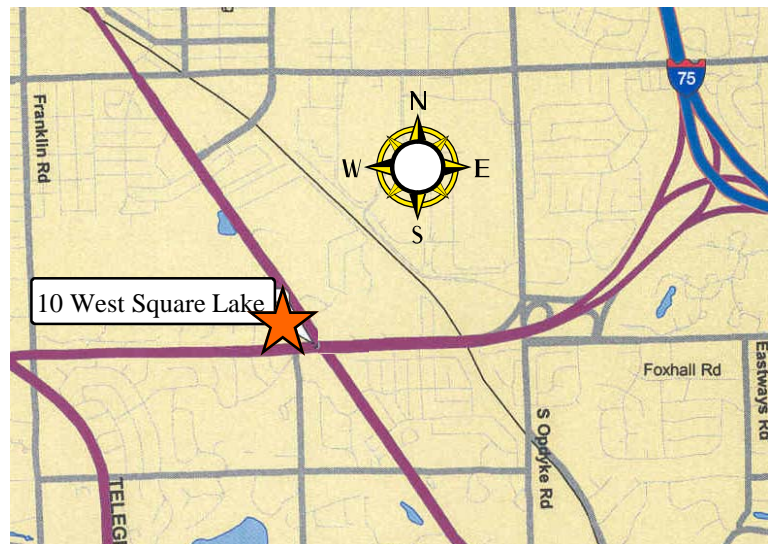

Property Managed and Leased by:

ARI-EL

Ari-El Enterprises, Inc.

29548 Southfield Road, Suite 200
Southfield, MI 48076-2028

(248) 557-3800 Fax (248) 557-6442

www.ari-el.com

Mmeredith@ari-el.com

ScottL@ari-el.com

**For further information or
to schedule a tour,
please contact:
Marilyn Meredith
or
Scott M. Leibovitz**

Information is subject to verification and no liability for errors or omissions is assumed. Price and terms are subject to modification.